



Lockside House, Chelsea Creek
Fulham SW6

GARTON JONES.COM



Lockside House, Chelsea Creek Fulham, SW6

GARTON JONES.COM

13 Park Street
Chelsea Creek
London
SW6 2FS

Sales +44 (0) 20 7824 7090
paul@gartonjones.com
www.gartonjones.com

£650,000 Leasehold

A rare opportunity to acquire a larger-than-average one-bedroom apartment in the sought-after Chelsea Creek development by Berkeley St George. Spanning 665sqft (61 sqm), this well-appointed home access to two private balconies. The bright, open-plan living/dining space measures an impressive 29'1 x 11'5 (8.8m x 3.4m) and features a modern kitchen with integrated appliances. The spacious double bedroom and sleek bathroom complete this stylish and practical layout. Development Features includes, residents' gym, swimming pool, spa & sauna, 24-hour concierge service, Beautiful canal-side setting & built by the award-winning Berkeley St George.

Service Charge - £5500
Ground Rent - £350
Lease 999 Years From 1st June 2010

Council Tax — London Borough Of
Hammersmith & Fulham Council Band E

EPC B (82)

- One Bedroom
- 4th Floor With Lift
- 665sqft (61sqm)
- Idyllic Dockside Location
- Open Plan Lounge — Kitchen Area
- Two Balconies
- Integrated Appliances
- High Specification
- Residents Spa — Gym & Swimming Pool
- EPC B (82)

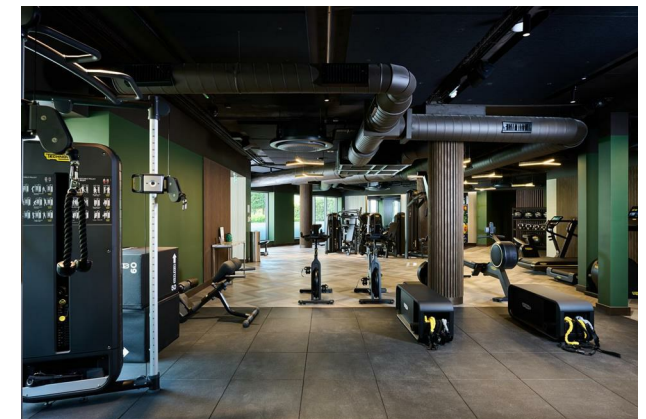

EPC certificate available on request.

Lockside House

Approximate Gross Internal Area = 665 sq ft / 61.8 sq m

Balcony = 64 sq ft / 6 sq m

GARTON JONES
LONDON

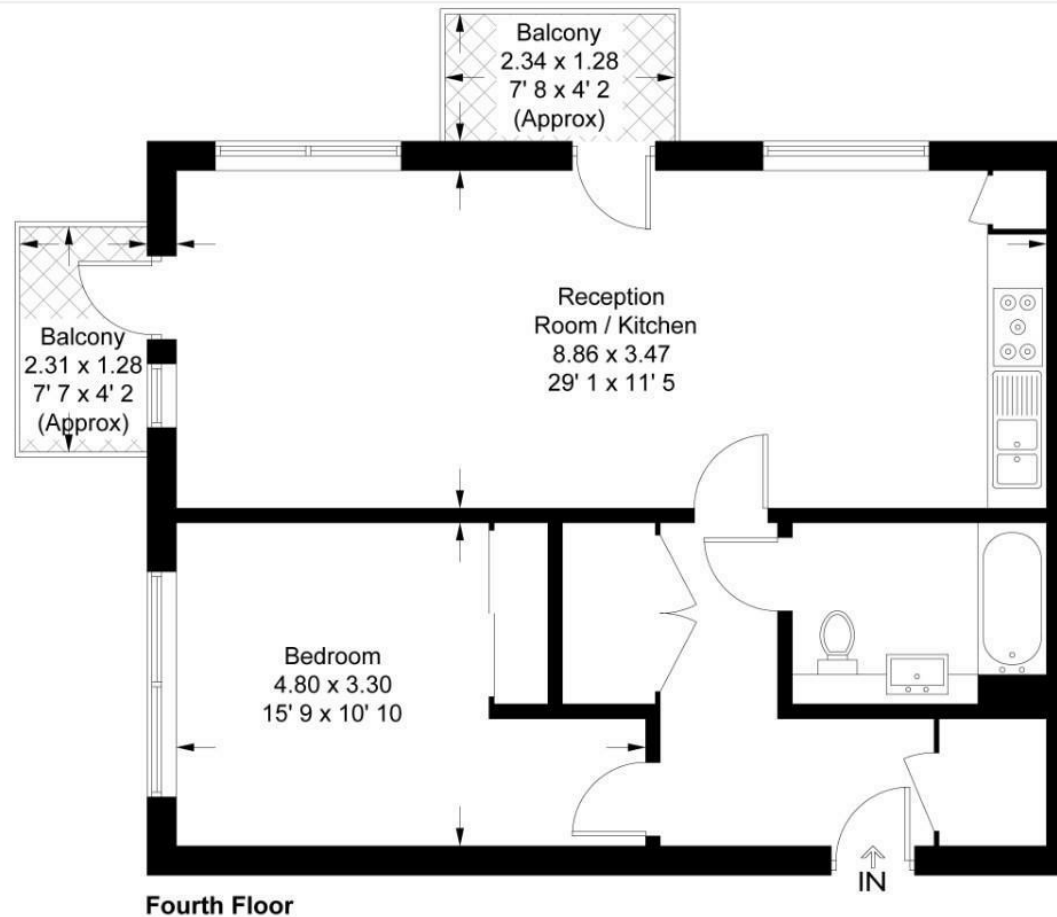

This plan is not to scale and must be used as layout guidance only. All measurements and areas are approximate and should not be relied upon to provide accurate information. This plan must not be relied upon when making property valuations, design considerations or any other such relevant decisions. We accept no responsibility or liability (whether in contract, tort or otherwise) in relation to any loss whatsoever arising from or in connection with any use of this plan or the adequacy, accuracy or completeness of it or any information within it.



